

K&F Line 212-6 – SP



- 2+1-way full-range system with integrated driver and power amplifier technology
- 12" woofer, 12" low-mid chassis, 1.5" high frequency driver on rotatable 65° x 50° CD-horn
- FLC® technology (frequency-dependent line coupling)
- 135 dB max. SPL

The Line 212-6 – SP is an active plug-and-play full-range system for high-quality, assertive medium to wide/wider-range sound reinforcement applications.

With the patented FLC technology implemented in the horn-loaded Line 212, a pronounced acoustic power concentration in the lower frequency spectrum is achieved. Therefore, two 12" high performance chassis are acoustically linked to become a column speaker (line). The chassis are driven with phase-matched signals in frequency bands with different widths.

The Line 212-6 – SP is a multi-purpose speaker system and is suitable for stand-alone applications or combined with other Line 212 in clusters. Combinations with the 90° x 50° emitting Line 212-9 – SP are also possible. If necessary, the system can be supplemented with additional subwoofers. The speaker can be mounted in vertical or horizontal direction.

The active system electronics contain 2 convection-cooled and highly efficient digital power amplifiers with a total power of 2 kW, an active frequency crossover and the basic equalisation of the Line 212. Optimum operating safety is provided by the elaborate limiter section with its RMS limiter in feed-forward configuration, followed by the peak limiter in feed-back design.

The compact enclosure is equipped with 2 butterfly handles, 5 flying points and a flying track. The optional 'Click & Fly' Flyware (BG certified) can be mounted without any tools and allows for flown combinations with the subwoofers SW 215E/SW 215E – SP.

The Line 212-6 – SP is a flexible and highly effective sound reinforcement tool in the highest category of professional 'Self-Powered' speaker systems.

K&F Line 212-6 – SP

Design	2+1-way full-range system with integrated driver and power amplifier technology, completely horn loaded, bass reflex tuning
Frequency response -10 dB	51 Hz – 20 kHz (FILTERS 'ON') 65 Hz – 20 kHz (FILTERS 'OFF') 49 Hz – 20 kHz (FILTERS 'OFF', with Controller)
Frequency response -10 dB	66 Hz – 18 kHz (FILTERS 'ON') 130 Hz – 18 kHz (FILTERS 'OFF') 60 Hz – 20 kHz (FILTERS 'OFF', with Controller)
Coverage angles nominal	65° x 50° (hor. x vert.), rotatable horn
Max. SPL	135 dB (SPL peak/1 m)
Components	1 x 1.5" high freq. driver with 75 mm titanium dome, 1 x 12" woofer, 1 x 12" low/mid chassis with horns, crossover active (1) and passive (2) in FLC-technology, delay time correction and phase optimisation self-resetting protection circuit for 1.5" driver
Connectors	LINE IN: XLR 3 pin female, LINE OUT: XLR 3 pin male, parallel with LINE IN, Pin 1=ground/ Pin 2=+signal/ Pin 3=-signal, Neutrik Power-Con lockable, 1 input, 1 x output

Input Module

Input sensitivity	+6 dB/1.55 Vrms for rated output
Input impedance	50 kΩ (balanced/unbalanced)
Common mode rejection	Min.: 74 dB, typical: 90 dB

Controls	Level control ±6 dB, bypass switch for the active filters (for operations with K&F System Controller), ground lift switch
-----------------	---------------------------------------------------------------------------------------------------------------------------

Display	Bi-coloured LED: green=Power On, red=Limit/Protect
----------------	----------------------------------------------------

Driver circuit	High pass 45 Hz (-3 dB), 24 dB/octave (FILTERS 'ON'), Phase correction, frequency equalisation (EQ), peak limiter, RMS limiter
-----------------------	--------------------------------------------------------------------------------------------------------------------------------

Amplifier Module

Type	Class D
Power	1000 W @ 8 Ω (EIAJ)
Power bandwidth	10 Hz to 30 kHz
Damping factor	>500 (100 Hz), >100 (10 kHz)
S/N ratio	>105 dB (A)
Cooling	Air convection (without fan)
Protection circuits	Short circuit, over-temperature, clipping, overload
Supply voltage	230 V version: AC 195 – 250 V, 50/60 Hz
alternative	115 V version: AC 95 – 125 V, 50/60 Hz
Power consumption nominal	@ 230 V: 1,25 A @ 115 V: 2,5 A
Burst current (Irms/<500 ms)	@ 230 V: 7 A @ 115 V: 14 A
Idle Current	@ 230 V: 200 mA @ 115 V: 400 mA

Enclosure

	Trapezoidal enclosure out of 15 mm multiplex with highly resistable structured paint (PU) in RAL 9005 (black), 2 butterfly handles, 4 non-abrasive plastic sliders, stacking grooves for identical enclosures, 4 flying points 'allsafe Jungfalk' and 1 rear mounted flying track 'allsafe Jungfalk', 2 locking profiles for optional transport cover with castors, ball proof steel grille with exchangeable acoustic foam (black) in front of the grille
Dimensions (W x H x D)	429 x 1025 x 510 mm
Weight	60.5 kg
Colour	RAL 9005 (black), RAL special colour
Accessories	See catalogue or www.kling-freitag.com

Horizontal coverage pattern

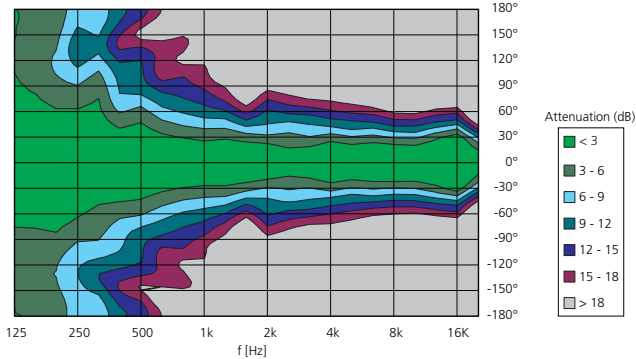

Vertical coverage pattern

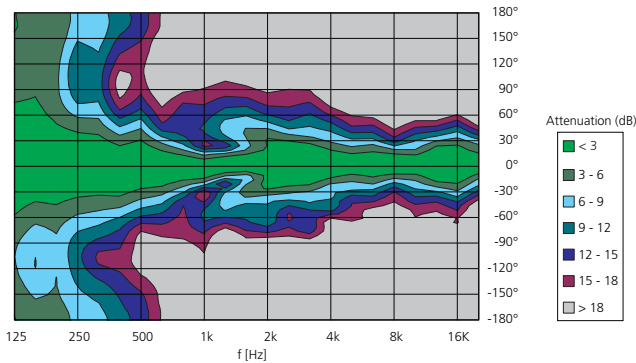

Frequency response 'on axis'

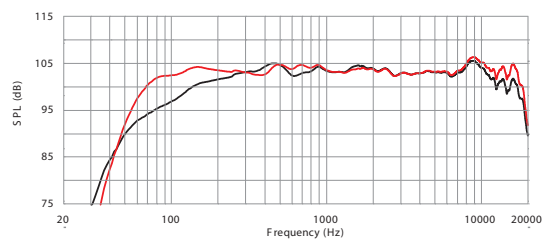

Beamwidth

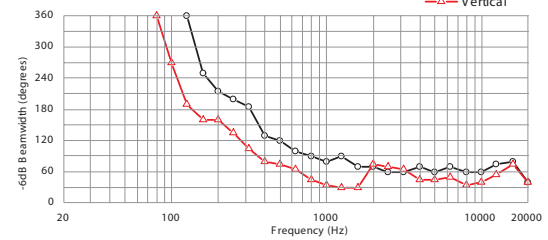

Directivity

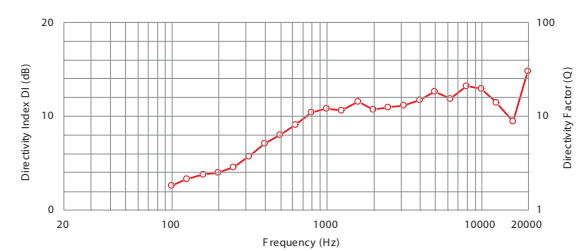

All measurements under free field conditions. Frequency diagrams 1/6 octave averaged, radiation and polar pattern 1/3 octave averaged. The manufacturer reserves the right to make product alterations to improve product quality without prior notice. Errors excepted.

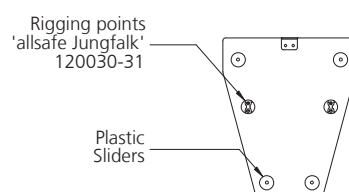
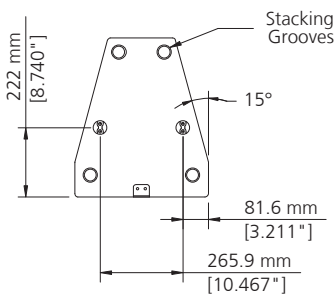
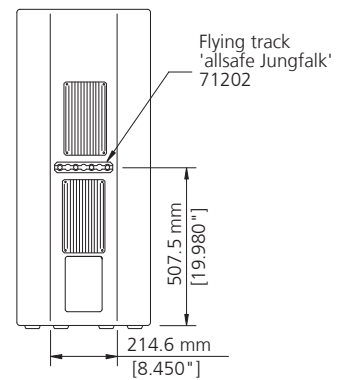
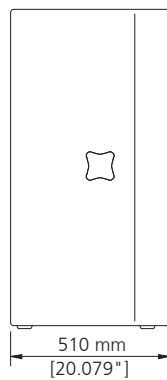
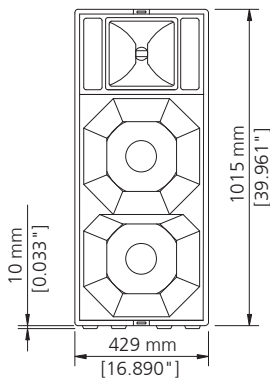

Further information and data like specifications, manuals, technical drawings as DWG, DXF and PDF files as well as data files for acoustic simulations with Ease and Ulysses are available on our web site www.kling-freitag.de

KLING & FREITAG GmbH
Wohlenbergstr. 5
D-30179 Hannover
Tel. +49 (0)511 96 99 7-0
Fax +49 (0)511 96 99 7-97